

TELEPHONE DIRECTORY

JANUARY 1972

*auto
2476
Lao*

FIRE

6222

KM-6.....K-92
(Lao spoken only)

AIR AM.....B-60

MEDICAL

6666

6450

TABLE
OF
CONTENTS
PAGE 1

MISSION GUARD

SERVICE

6434

7175

MARINE GUARD

EMBASSY..... 7178

USAID..... 6221

DIALING INSTRUCTION

FROM TO	Compound 4 digit no.	Air America "B"	KM-6 & KM-9 "K"	City Exchange "PTT"	Class "A" Subscriber
Compound	dial number	0* number	0* number	PTT-2071/2126 pass to opr	dial no.
Air America	6601 pass to opr	dial number	0* 6601 pass to opr	PTT-2071/2126 pass to opr	6601 pass to opr
KM-6 & KM-9	3* number	0* 3* number	dial number	PTT-2071/2126 pass to opr	3* number
City Exchange	9* number	0* 9* number	0* 9* number	dial number	9* number
Air America Operator	6601	10	0* 6601	PTT-2071/2126 pass to opr	6601
Compound Operator	0	0* 0	0* 0	PTT-2071/2126 pass to opr	0
Luang Prabang Tel. Operator	6202	0* 6202	0* 6202	PTT-2071/2126 pass to opr	6202
Pakse Tel. Operator	6202	0* 6202	0* 6202	PTT-2071/2126 pass to opr	6202
Savannakhet Tel. Operator	6202	0* 6202	0* 6202	PTT-2071/2126 pass to opr	6202
Vang Vieng Tel. Operator	6202	0* 6202	0* 6202	PTT-2071/2126 pass to opr	6202
Thakhek Area Radio Opr	6265	0* 6265	0* 6265	PTT-2071/2126 pass to opr	6265
Houei Sai Area Radio Opr	6175	0* 6175	0* 6175	PTT-2071/2126 pass to opr	6175
Sayaboury Area Radio Opr	6175	0* 6175	0* 6175	PTT-2071/2126 pass to opr	6175
Vientiane Area Radio Opr	6210	0* 6210	0* 6210	PTT-2071/2126 pass to opr	6210
VHF Net Radio Operator	6508	0* 6508	0* 6508	PTT-2071/2126 pass to opr	6508
Xieng Khouang Area Radio Opr	6508	0* 6508	0* 6508	PTT-2071/2126 pass to opr	6508
Bangkok USAID/Laos	0	0* 0	0* 0	-	8-984-4235
Long Distance Direct Dial	0	0* 0	0* 0	-	8* 3 digit code + no.
JOSS -					8* 8
Autovon	0	0* 0	0* 0	-	8-985-1110

* = wait for dial tone then dial number or pass to operator

See page 29 for instruction to call "B" number during 1730H - 0800H.

Information	...	7101
Report Trouble	...	7201

Class "A" subscribers have unrestricted service. All other subscribers are restricted to the local area only. unless authorized by special request.

No access to the automatic long distance system will be provided from KM-6 and Air America. All calls must be placed through the operator.

Vientiane Area Code for Class "A" = 977

TABLE OF CONTENTS

<u>Organization or Unit</u>	<u>Page No.</u>	<u>Organization or Unit</u>	<u>Page No.</u>
Accounts (USAID)	16	Finance (USAID)	16
Administrative Analyses Staff	12	Financial Management (USAID)	16
Administration Section (EMB)	3	Fire Department	5
Agricultural Dev. Org. (USAID)	9	Flight Schedule	45
Agriculture (USAID)	8-9	General Services (EMB)	4
Air America	27-30	Guest House (USAID)	36
Airlines	39	Hospitals	40
Air Schedules (USAID)	45	Hotels	40-41
Air Support (USAID)	12	Housing (USAID)	13
Ambassador	3	Human Resources Dev. (USAID)	11
American Community Assn.	33-34	Inspections & Investigations Staff (IIS)	11
American School	32	International Control Commission	41
American Women's Club	34	International Organizations	41
APO	4, 32	International Voluntary Services	11
Area Coordinator: (USAID)		Japanese Voluntary Service	41
Ban Houei Sai	8	Joint Alert Notification Office (JANO)	26
Luang Prabang	8	Lao-American Association	6, 36-37
Pakse	8	Library (AWC)	34
Savannakhet	8	Library (USAID)	14
Sayaboury	8	Library (USIS)	6, 37
Vientiane	8	Locations (Organization/Unit/Office)	
Xieng Khouang	8	Inside Back Cover	
Asia Foundation	41	Luang Prabang Directory	20-21
Assistant Director: (USAID)		Maintenance (EMB)	4
AD/FIN	16	Maintenance (USAID)	13
AD/FO	8	Management (USAID)	12
AD/M	12	Marine Security Guard	5
AD/PE	17	Medical Unit	4, 37
AD/RA	17	Messenger Run/Stop	25
Attache, Air	7	Ministers & Secretaries of State	
Attache, Army	7	(RLG)	43-44
Auditor General, Laos	9	Mission Guard Service	5
Bangkok Operations Office	12	Motor Transport (USAID)	13
Banks	39	OICC	18
BNDD	5	Pakse Directory	22-23
Budget & Management (EMB)	4	Personnel (EMB)	4
Bus Schedule	38	Personnel (USAID)	13
Business Houses	39	Political Section (EMB)	3
Catholic Relief Services	41	Post Office (APO)	4, 32
Churches	34-36, 40	Program (USAID)	18
Colombo Plan	41	Program & Economic Affairs (USAID)	17
Commissary (ACA)	34	Property Management (USAID)	13
Communications Media (USAID)	12	Public Health (USAID)	17
Communications & Records (EMB)	4	Public Safety (USAID)	18
Communications & Records (USAID)	12	Public Works (USAID)	18
Consular Section (EMB)	3	Refugee Affairs (USAID)	17
Continental Air Services	31	Requirements Office (USAID)	18-19
Contract Services (USAID)	12	Research & Management (USAID)	14
Deputy Chief of Mission	3	RLG Offices	41-42
Deputy Director USAID	8	Savannakhet Directory	24
Director, USAID	8	Schools	32, 42
Director, USIS	6	Security Branch (EMB)	5
Disbursing Office (EMB)	4	Supply Management (USAID)	14
Disbursing Office/Cashier (USAID)	16	Telecommunications (EMB)	4
Dispatcher (EMB)	4	Telecommunications (USAID)	16
Dispatcher (USAID)	13	Telephone - Information/Repair	Inside
Dooley Foundation	41	(Compound #)	Front Cover
Economic Affairs (USAID)	10	Telephone - Information/Repair	
Economic Section (EMB)	3	(PTT #)	42
Education (USAID)	10	Translation (USAID)	16
Embassies	44	Transportation (USAID)	16
Emergency Action Officer	12	United Nations Organization	41
Evaluation & Program Management		USIS	6, 37
(USAID)	10	World Health Organization	41
Federal Highway Admin. (USAID)	10-11		

QUICK REFERENCE: EMERGENCY NOTIFICATION NUMBERS

		<u>Weedburner</u>	<u>JANO</u>	<u>Sherlock</u>	<u>Office</u>	<u>Home</u>
Ambassador **		50		50*	7121	7155
DCM **		51		51*	7122	6662
EMB/ADM (E&E Officer)	Robinson**	24		24*	7125	6631
Asst E&E Officer **	Levis**	21		21*	6106/6545	7353
E&E Operator						
RSO	McGuire**			E&E Base		
Marine Guard Chancery				23*	7116	6634
				Sherlock/ Base	7178	7331
NCOIC/MSG **	Lee**			22*	7160	7325
EMB Duty Officer				27*		
Medical Duty Officer *				30*		
Mission Guard Chief	Mushett			37	7175	7108
MGS Supervisor on Duty		MGS Base			7175	6434
MGS Radio Operator		MGS Base			7175	6434
General Services Officer	Russillo			68	7114	7350
POL	Howland	54		54	7118	6688
POL	Tovar	55		55	7132	6638
ARMA	Frye	59		59	7197	7112
ARMA Duty Officer		60		60	6520	
ARMA (Compound)		60		60	6520	
ARMA (MR-V)					7167	
AIRA	Curry	58		58	6595	7163
AIRA Duty Officer				48	7354	
USAID						
Director	Mann**	52		52*	6100	6543
Deputy Director	Chandler**			53*	6101	6600
AD/M (JANO)	Carr**	26		26*	6105	6477
Alternate JANO	Ostertag**		25	25*	6106	6154
Assistant JANO	Legg**		19	19*	6107	6554
Emergency Action Officer	Levis**	21		21*	6106	7353
JANO Radio Operator	Ditter				6105	K128
JANO Radio Operator-Backup	Allen			Base @ Base @	6218	6183
Marine Guard Bldg #100					6221	
USAID Duty Officer			28	28*		
Chief, Requirements Office	Newman				6530	6255
Chief, Public Safety	Landgren			29*	6515	6277
Motor Transport Office	Croasdell			43	6132	K63
Chief, Air Support	Leonard	45		45*	6199	6485
Deputy Chief, Air Support	Gabeler				7131	6636
Property Management Officer	Pearcy				6120	6169
Power Section	Daveler				6139	6192
Telecom Officer	Nicolay	44	44	44	6200	6487
Telecom Operator		USAID Base		USAID Base	6201	
Area Coordinator/VTE	Young				6246	6480
USIS Director	Barnes**	56		56	7188	7145
Air America Base Manager	Cunningham				7293	6665
Air America Security Off	Hart				B-53	6437
Air Operations Center(24-hrs)				46	6505	
CASI Base Manager	Brongersma				6606	6104
CASI Office/Operations				47	6606	
Chief, Sector I **	Ito		11*		6234	6198
Chief, Sector II **	McElhoe		12*		7120	7332
Chief, Sector III **	Naughton		13*		7183	6687
Chief, Sector IV **	Albert		14*		7186	7148
Chief, Sector V **	Richardson B.		15*		6219	K88
Chief, Sector VI **	Duke		16*		6519	-
Chief, Sector VII **	Brundage		17*		6401	6274
Chief, Sector VIII **	Fields		18*		K96	K110

* Pocket Pager

** Selective Call: May be reached through SHERLOCK BASE, USAID BASE, or MGS BASE (all 24-hour operations) or E&E BASE or JANO BASE during working hours or emergency alerts.

@ During emergency alert only.

TELEPHONE FUNCTIONAL LISTINGS

AMERICAN EMBASSY - CHANCERY

OFFICE OF THE CHIEF OF MISSION (AMB)

AMBASSADOR - G. McMurtrie Godley	7121/7122 PTT 2357
Secretary - Marilyn F. Jackson	7121/7122 PTT 2357

OFFICE OF THE DEPUTY CHIEF OF MISSION (DCM)

Deputy Chief of Mission & Counselor of Embassy Monteagle Stearns	7121/7122 PTT 2357
Secretary - Elma Udall	7121/7122 PTT 2357

POLITICAL SECTION (POL)

Officer-in-Charge - Chief, Richard C. Howland	7118/7126
---	--------	-----------

ECONOMIC SECTION (ECON)

Counselor of Embassy for Economic Affairs/ USAID/Laos Director - Charles A. Mann	6100/6103
Commercial Officer - Adger E. Player	6215

CONSULAR SECTION (CONS)

Consul - S. Richard Rand	7110
--------------------------	--------	------

ADMINISTRATIVE SECTION (ADM)

Counselor of Embassy for Administrative Affairs Reed P. Robinson	7125
Administrative Officer - Paul E. Kelly	6110

AMERICAN EMBASSY - Cont'd

BUDGET AND MANAGEMENT BRANCH (B&M)

Budget and Management Officer - Cherry C. Stubbs	7119
Budget and Fiscal Officer - Chester W. McElhoe	7120
Disbursing Officer - Sara E. Shonk 	7120

COMMUNICATIONS & RECORDS BRANCH (C&R)

Communications & Records Officer R. Phillip Hendrix 	7129
Telecommunications Unit (TELE) Marvin H. Chindgren 	7128/7171
APO Unit - Mary E. Miller 	6114

GENERAL SERVICES BRANCH (GSO)

General Services Officer Victor Russillo 	7114/6642
Dispatcher - Embassy Compound 	7194
Silver City 	7377
Building & Maintenance Unit - Lester E. Miller	7157/7385
Customs/Shipping/Procurement/Transportation Edward L. Howell 	7133/6635

MEDICAL BRANCH (MED)

Post Medical Officer - David A. Hungerford, MD	6450/6666
--	-----------

PERSONNEL BRANCH (PER)

Personnel Officer - Esther M. Rice 	7168/7170
---	-----------

AMERICAN EMBASSY - Cont'd

SECURITY BRANCH (SY)

Regional Security Officer - Elwood J. McGuire ... 7116/7195

Marine Security Guard Unit (MSG)

Non-Commissioned-Officer-in-Charge

GY/SGT Thomas L. Lee ... 7160

Marine Security Guard - EMBASSY ... 7178

Marine Security Guard - USAID ... 6221

Marine Security Guard - RESIDENCE ... 7331

Mission Guard Service Unit (MGS)

Howard F. Mushett ... 7175/6434

Fire Department ... 6223

Fire - Report Desk ... 6222

Na Hai Diao Compound - Gate 1 ... 6443

Na Hai Diao Compound - Gate 2 ... 6441

KM-6 Gate ... K-91

BUREAU OF NARCOTICS & DANGEROUS DRUGS (BNDD)

Narcotics Attache (NA) - Anthony J. Morelli ... 7343

TELEPHONE FUNCTIONAL LISTINGS

AMERICAN EMBASSY - USIS

OFFICE OF THE DIRECTOR

Director - Norman C. Barnes	7188
Secretary - Judith L. Anderson	7188/7185

ADMINISTRATIVE OFFICE

Executive Officer - Gilbert I. Laskowski	7184
--	--------	------

CULTURAL AFFAIRS OFFICE

Cultural Affairs Officer - Wilfred P. Allard	7189
LAA Director - John M. Reid	7158/7258
Library	7182

INFORMATION DIVISION

Information Officer - Clifton B. Naughton	7183
Press Attache - Andrew P. Guzowski	7181/7166
Publications & Exhibits Officer - Jack M. Barker	7181
Radio Section Chief - Khamsin Souphasiri	7187

BRANCH PUBLIC AFFAIRS OFFICES

Branch Public Affairs Officer/Vientiane Frank L. Albert	7186
Branch Public Affairs Officer/Pakse Robert W. Proctor	6202

SPECIAL PROJECTS OFFICE

Special Projects Officer - John R. Miley	7186
--	--------	------

TELEPHONE FUNCTIONAL LISTINGS

OFFICE OF THE MILITARY ATTACHES

ARMA - ARMY ATTACHE

Attache - Col. John W. Frye	7197
Deputy ARMA - LTC Eldon L. Cummings	7162
Operations Officer	6520 / 7232
Communications Officer	6525
Administrative Officer	6433
Duty Officer/Duty NCO	6520

AIRA - AIR ATTACHE

Attache - Col. Hayden C. Curry	6562
Assistant Air Attache	6595
Duty Officer	7354

TELEPHONE FUNCTIONAL LISTINGS

AMERICAN EMBASSY - USAID

OD - OFFICE OF THE DIRECTOR

Director - Charles A. Mann	6100/6103 PTT 2733
Deputy Director - James B. Chandler	6101

AD/FO - OFFICE OF THE AD/FO

Assistant Director for Field Operations		
Loren E. Haffner	6249/6241
Phillip J. Buechler, Assistant	6249/6241
Area Coordinator/Ban Houei Sai (AC/BHS)		
John W. Greenough	6175
Area Coordinator/Luang Prabang (AC/LP)		
Anthony J. Cauterucci	6202
Area Coordinator/Pakse (AC/PS)		
Louis Connick	6202
Area Coordinator/Savannakhet (AC/SVKT)		
Sanford J. Stone	6202
Area Coordinator/Sayaboury (AC/SBY)		
Dwane E. Hammer	6175
Area Coordinator/Vientiane (AC/VTE)		
Earl J. Young	6246
Area Coordinator/Xiang Khouang (AC/XK)		
Edgar M. Buell	6298

CDS - COMMUNITY DEVELOPMENT STAFF

Chief - Robert C. Anderson	6240/6241
Admin. Asst. for Activity Plans	6245
Logistic Coordinator	6245
Personnel Air Travel Arrangement	6245

AGR - AGRICULTURE DIVISION

Chief - Leroy H. Rasmussen	6400/6401
Deputy Chief - Donald R. Mitchell	6400/6401

USAID - Cont'd

AGR - AGRICULTURE DIVISION (Cont'd)

Administrative Planning Branch		
Chief - John B. Woods	6400/6401
Administrative Support Section	6401
Operations Section	6611
Agro-Industry Branch		
Chief - Richard Clark	6418/6527
Refugee Affairs Liaison - John H. Huxtable	6416/6419
Economics Branch		
Chief - Kenneth P. Brundage	6400/6401
Fisheries Branch		
Chief - Saburo Sugitani	7107
Information Branch		
Chief - Joseph L. Budy	6402
Irrigation Branch		
Chief - Lester A. Robb	6612
Planning Section	6122
O & M Section	6612
Office Engineering Section	6611
Livestock Branch		
Chief - Clyde M. Richardson	6611
Extension Branch		
Chief - Van B. S. Henderson	6404
Home Economics Section	6611
Research Branch		
Chief - Francis J. Bell	6402
USAID AGR Office at RLG Agriculture	6404

ADO - AGRICULTURE DEVELOPMENT ORGANIZATION

Executive Manager - William E. Schaefer	6403/6563
Vientiane Area Branch Office	6503

AUD - AUDITOR GENERAL/LAOS RESIDENT OFFICE

Resident Auditor - Kenneth G. Wagner	6231
Staff	6229

USAID - Cont'd

EAD - ECONOMIC AFFAIRS DIVISION

Chief and Senior Economic Advisor		
Halsey M. Wilbur (Acting)	6218
Credit and Banking Advisor - Halsey M. Wilbur	6419
<u>PA</u> - Public Administration Advisor	6215
Charles F. B. Wilding-White		PTT 2239 Ext. 27
Commercial Officer of Embassy - A. E. Player	6215
Program Economist	6215

EDU - EDUCATION DIVISION

Chief - Norman W. Green	6406/6407
Community Education Branch		
Chief - Hunter A. Fitzgerald	6408/6409
Secondary Education Branch		
Chief - Lucius Butler	6464
Teacher Education Branch		
Chief - James A. Colman	6465
University of Hawaii Team		
Chief of Party - Lucius Butler	6464
Procurement & Logistics Officer - John Rantala	6464
Fa Ngum Curriculum Development Office	6669

EPM - EVALUATION & PROGRAM MANAGEMENT DIVISION

Chief - Anthony H. Wirtz	6214
Program Management Processes (PMP) Branch		
Chief - Lea Knott	6216
Program Management Information (PMI) Branch		
Chief - Joseph M. Chudzik	6219

FHWA - FEDERAL HIGHWAY ADMINISTRATION

Chief - Benjamin D. Stewart, Jr.	6411
Deputy Chief - Hollis Glass	6411
Administrative Officer - Edmond M. Schnoeker	6412

USAID - Cont'd

FHWA - FEDERAL HIGHWAY ADMINISTRATION (Cont'd)

Equipment Branch		
Chief - Howard F. Harper	6163
Materials Laboratory		
Chief - Richard D. Ledbetter	6413
Supply Branch		
Chief - Duane A. Martin	6164
Training Branch		
Chief - Ralph M. Piercy	6413
PK-7 Shop		
Woodrow Jones	6163
Clement P. Litvinas	6163
PK-7 Warehouse		
Henry H. Kvalvik	6164
Harold D. Hartman	6164
PK-7 Training School		
Larry E. Jones	6413

HRDD - HUMAN RESOURCES DEVELOPMENT DIVISION

Chief - Henry Beyda	6236
---------------------	--------	------

HRDD/LT - LOCAL TRAINING BRANCH

Chief - Dayton L. Maxwell	6239/6439
Lao Language Assistant	6526
Clerical Training Assistant	6466

HRDD/PT - PARTICIPANT TRAINING BRANCH

Chief - Ruth M. LeBert	6238
------------------------	--------	------

IIS - INSPECTIONS & INVESTIGATIONS STAFF

Resident Inspector - Charles M. Morris	6484/6264 *
--	--------	-------------

* If no answer, call 6108.

IVS - INTERNATIONAL VOLUNTARY SERVICES

Director - Valdemar H. Petersen	6460/6247
Associate Director/Education - Michael A. Fields	6247/K-96
Associate Director/Administration - Stephen J. Ford		6247/K-110

USAID - Cont'd

MGT - OFFICE OF MANAGEMENT

Assistant Director for Management (AD/M)

Harry L. Carr	6105/6106
Deputy Executive Officer - F. Samuel Ostertag	6105/6107
Management Planning Officer - Phillip N. Legg	6106/6107
Contract Services Officer - Herbert L. Sultan	6107/6108
Emergency Action Officer - William A. Levis	6105/6545

AAS - ADMINISTRATIVE ANALYSES STAFF

Chief - Joseph T. Murphy	6172
--------------------------	--------	------

ASB - AIR SUPPORT BRANCH

Chief - William R. Leonard	6112/6199
----------------------------	--------	-----------

BKK - BANGKOK OPERATIONS OFFICE

Chief - Franklin P. Harrison, Jr.	8-984-4541
Port Operations Officer - Sanford L. Chance	8-984-4235
Administrative Section - Barbara J. Kaltoff	8-984-4235
Procurement Section - Mr. Lim	8-984-4235
Travel Section - Mr. Samarn	8-984-4235
General Services - Mr. Sombat	8-984-4235
Warehouse - Mr. Robert	8-984-4235
ACA COMM Whse - Mr. Suraphong	8-984-4235
Port Office, Klong Toey - Mr. Saman	8-982-7257

CM - COMMUNICATIONS MEDIA BRANCH

Chief - Kenneth L. Ross	6116
Publications	6117

C&R - COMMUNICATIONS & RECORDS BRANCH

Chief - Ellen McMahon	6113/6179
Unclassified Section Supervisor - Mr. Thanh	6115

USAID - Cont'd

MGT - OFFICE OF MANAGEMENT (Cont'd)

MTB - MOTOR TRANSPORT BRANCH

Chief - Theodore P. Croasdell	6132
Dispatcher - Compound	6133/7217
Dispatcher - KM-2	6625
Cargo Movement	6625
Accounting & Personnel Section	6558
Maintenance & Repair Unit	6699
Supply Unit	6632

PERS - PERSONNEL BRANCH

Personnel Officer - Henry Raden	6135/6136
Asst. Personnel Officer	6135/6136
Asst. Personnel Officer (Local)	6137/6138
I. D. Card Photo Room	6442

PMB - PROPERTY MANAGEMENT BRANCH

Chief - Charles R. Percy	6120/6121
--------------------------	--------	-----------

HSG - Housing Section

Housing Officer - John A. Douglas	6178/6180
Guest House Reservation/Receptionist	6178
Assignment & Inspection	6180

MTE - Maintenance Section

Chief - Willis F. Usry	6130/6131
Janitorial Services	6614

<u>PLG - Planning & Engineering Section</u>	6294
---	--------	------

PRA - Property Accounting Section

Chief - Ernest F. Bonnett	6125
Inventory Unit	6474
Warehouse	6123/6127

USAID - Cont'd

MGT - OFFICE OF MANAGEMENT (Cont'd)

PMB - PROPERTY MANAGEMENT BRANCH (Cont'd)

PWR - Power Section

NIGHT
POWER
6131
6139

Chief - Harold S. Daveler	6120/6139
Asst. Chief - Richard D. Broadway	6139/6140
Administrative Unit	6139/6140
Power House - Compound	6548
Power House - KM-6	K-95
Power House - O. B.	6160
Power House - Thong Compound	6686
Universal American Enterprises, Inc.	6440

RMB - RESEARCH AND MANAGEMENT BRANCH

Chief - Ray Drummond	6118
Deputy Chief - Ernest D. Berkaw	7130
Management Section	6119
Research Section	6556

SMB - SUPPLY MANAGEMENT BRANCH

Chief - Joseph W. Ruane, Jr.	6422
------------------------------	--------	------

SMA - Customer Supply Assistance

Customer Supply Assistance Officer Charles L. Christiansen	6432
---	--------	------

PROC - Deputy Chief for Procurement

Hugh A. Fincher	6424
Procurement Section		
Procurement Officer		
Margaret T. Brasile	6424
Business Service Center	6447
Technical Library	6447
Technical Section	6504
Excess Property Section	6438
Property Utilization Officer - Hans Bang		7286
Commodity Import Program Section	6426

USAID - Cont'd

MGT - OFFICE OF MANAGEMENT (Cont'd)

SMB - SUPPLY MANAGEMENT BRANCH (Cont'd)

SUP - Deputy Chief for Supply

Susumu Ganiko 6423

SCS - Supply Control Section

Supply Control Officer - Paul A. Robinson 6429

Inventory Management 6430

Replenishment 6506

Project Stock and Cement 6431

Ready Issue Room 6126

POL Management 6432

Central Parts Control (CEN)

Central Parts Control Officer

Melvin B. Ein 6429

Heavy Equipment & Vehicle Parts ... 6280

SDS - Supply Data Systems Section

Supply Data Systems Officer

W. Wayne Brady 6425

Data Preparation 6425

FEDSTRIP/MILSTRIP 6427

Systems Support 6425

SWS - Supply Warehouse Section

Supply Warehouse Officer

John H. Stalcup 6176

Field Warehouse

Field Warehouse Officer

Henry U. Palmer 6289

Central Warehouse 6289/6561

Special Warehouse 6289/6561

Parts Warehouse & Open Storage

(Kao Liao) 7309

Warehouse No. 9 6276

Warehouse (KM-14) 6202/Oper. KM-14

MTB Vehicle Parts (KM-2) 6632

USAID - Cont'd

MGT - OFFICE OF MANAGEMENT (Cont'd)

TEL - TELECOMMUNICATIONS BRANCH

Chief - Albert A. Nicolay	6200
Operations	6201
Radio Shop	6528
Telephone Information	7101
Telephone Repair	7201

TLS - TRANSLATION SECTION

Chief - Vichian Busabaratana	6141
------------------------------	--------	------

TRP - TRANSPORTATION BRANCH

Chief - Raymond V. Walling	6142/6428
Cargo Movement Section	6144
Customs Section/Vehicle Registration	6617
Personal Effects Movement Section	6143
Travel Section	6145

OFIN - OFFICE OF FINANCE

Asst. Director for Finance (AD/FIN)

Ben L. Whiting	6225
Deputy Controller - Leon E. Vaughn	6224

ACC - ACCOUNTS BRANCH

Budget & Accounts Officer - James E. Allen	6227
Asst. B&A Officer - Steven G. Liapis	6227
Administrative Section	6456
Accounting Section	6226
Local Currency Accounting	6228
Certifying Officer - Thomas J. Nickle	6475
Cashier - Raymond E. Dropik	6235
Payroll Section	6230
Voucher Section	6232

FMB - FINANCIAL MANAGEMENT BRANCH

Chief - William F. Schrider	6234
Staff	6233

USAID - Cont'd

OPE - OFFICE OF PROGRAM AND ECONOMIC AFFAIRS

Asst. Director for Program and Economic Affairs

(AD/PE)

Gordon B. Ramsey	6212
Special Advisor to Commissioner of Plan			
Paul J. Maynard	6482/6213
Evaluation & Program Management			
Division (EPM)			
Chief - Anthony H. Wirtz	6214
Economic Affairs Division (EAD)			
Chief - Halsey M. Wilbur (Acting)	6419
Human Resources Development Division (HRDD)			
Chief - Henry Beyda	6236
Program Division (PRO)			
Chief - Richard J. Hynes	6216

ORA - OFFICE OF REFUGEE AFFAIRS

Asst. Director for Refugee Affairs (AD/RA)

John W. MacQueen 6242/ -43 -44

RAO - Refugee Affairs Officer - Jack L. Williamson 6242/ -43 -44

RAA - Refugee Affairs Administrative Branch

Chief - William C. Luken 6243

RRB - Refugee Relief Branch

Chief - George T. Cosgrove 6242

Logistic Officer - MacAlan Thompson 6242/ -43 -44

RRL - Refugee Relocation Branch

Chief - Hugh W. Brady 6242

FFP - Food for Peace Branch

Chief - Roger G. Sprowls 6242/6243

PHD - PUBLIC HEALTH DIVISION

Chief - Charles L. Weldon, M.D. 6510/6511

Deputy Chief - Lawrence F. Becker 6510/6511

Medical Warehouse 6512

USAID - Cont'd

PRO - PROGRAM DIVISION

Chief - Richard J. Hynes	6216
Regional Programs - Robert J. Asselin	6213

PSD - PUBLIC SAFETY DIVISION

Chief - Raymond H. Landgren	6515/6516
Communications Advisor	6515/6516
Generalist	6515/6516
PSD Maintenance	7356
Equipment Advisor	7356
Logistics-Supply Section	7256
Northern Province Advisor	6515/6516
Southern Province Advisor (SVKT)	6202
Narcotics Advisor	6515/6516

PWD - PUBLIC WORKS DIVISION

Acting Chief - Lee P. Gibson	6517/6518
Vertical Construction Branch			
Chief - David H. Duke	6517/6518
Horizontal Construction Branch (Khao Liew)			
Chief - Paul M. Rosal	7308
Equipment Section (RPWC)	6290
Transportation - Dispatcher	6549
Administration Branch			
Chief - Mildred C. Martz	6518/6519
Operations Branch			
Chief - Randolph H. Jetton	6518/6519
Public Utilities Branch			
Chief - Louis L. Fittro	6518/6519
Well Drilling Center (Khao Liew)	6290

OICC - OFFICER IN CHARGE OF CONSTRUCTION

ROICC - William P. Donnelly	6513/7310
-----------------------------	-----	-----	-----------

RO - REQUIREMENTS DIVISION

Chief - Ralph F. Newman	6530/6531
Deputy Chief - John M. Hogg	6530/6531
Administrative Branch			
Chief - Truman E. Brown	6530/6531
Publication Unit	6551
Radio Room	6288

USAID - Cont'd

RO - REQUIREMENTS DIVISION (Cont'd)

Aviation Branch		
Chief - Roger W. Starbuck	6532
Supply	6275
Maintenance	6275
Plan and Program Branch		
Chief - William Pollak	6254
Budget and Fiscal Section	6254
Training Section	6539
English Language Training Coord.	6534
Engineer Branch		
Chief - Tom S. Hatsukano	6538
Medical Branch		
Chief - Ramon D. Garrett	6541
Ordnance Supply Branch		
Chief - Walter R. Grimme	6533
Maintenance Section	6533
Ammunition Section	7263
Quartermaster Branch		
Chief - George C. Medlin	6537
POL Section	6566
Communications & Electronics Branch		
Chief - William L. Gill	6535
Field Liaison Branch		
Chief - Bill L. Mitchell	6478
Luang Prabang Office	6202
Pakse Office	6202
Savannakhet Office	6202
Xieng Khouang Office	6202
Vientiane Office - Chinaimo	7245
Transportation Branch		
Chief - Edward Ceaser	6536/6542
Warehouse Section	6555
Wattay Terminal Opns	7303

LUANG PRABANG

Telephone Directory

<u>Office</u>	<u>Number</u>
Area Coordinator	251/243
AC/Secretary	251/243
ADO	267
Agriculture	257
Air America Office	258
Air America Radio Station	264
Air Continental Office	204
Air Operations	241
ARMA	236
Cashier (Yuthana)	275
CDAA Office	255
Chao Khoueng Office	272
Dispatcher	263
Education	254
Embassy Representative	259
FHWA (BPR)	247
Field Support	252/271
Hawaii Team	202
Irrigation	262
LAA	250/268
Maintenance Shop (Sanan)	245
Medic (Vee Shoun House)	279
Mixed General Staff	206
M. R. 1	265
MTB	233
MTE Parts Room (Laosu)	237
Power House	219
PSD (Suwan)	269
PTT	223/224
PWD	255
Radio Operator (USAID)	222
Radio Shop	299
Refugee Relief	256
Requirements Office	253
SMB Warehouse	261
Switchboard	200
Supply Room (Bounkhiem)	276
USAID-II, Admin (Chern)	271/252

LUANG PRABANG

Telephone Directory - cont'd

<u>Residence</u>	<u>Tel. No.</u>	<u>Residence</u>	<u>Tel. No.</u>
AC Residence 211	Funke, George 226
Alcorriza, Felix 273	Long, John 216
AA House 270	Moreno, Dick 217
Apartment (USAID) 273	Norman, Price 250
ARMA House 236	O'Neil, Frank 215
Beck, Chip 246	Phoenix, Mike 266
Bewetz, Frank 228	Riddle, James 230
Bryant, Arria 225	Ruffino, Dan 240
Campbell, Jerry 205	Sanan, S. 239
Cavalcante, James 232	Sisavanh 278
Chern, S. 238	Sompop T. 244
Clark, Hervey 274	Thorne, Henry 227
Continental House 234	Vee Soun House 242
Des Brisay, Bligh 218	Wayne, Robert 231
Drew, Doug 229	Yamauchi, Shozun 213
Dunn, James 220		

PAKSE

<u>OFFICE</u>	<u>TELEPHONE DIRECTORY</u>	<u>NUMBER</u>
USAID Area Coordinator	10, 12
Secretary	12
Agriculture	28
Community Development	35
Community Development (Nelson)	15
Education	30
Federal Highway Administration (Gruhn)	86
Federal Highway Administration (Snyder)	87
Irrigation	75
Public Health	18
Public Works	68
Requirements Office	42
Field Support Officer	13
Secretary	20
Cashier	80
Dispatcher/Motor Vehicles	26
Guest House/USAID	64
Maintenance, Housing	27
Microwave Radio Station (TRC-90)	92
Motor Pool	68
Property	76
Radio Operator/Vientiane	22, 33, 44
Radio Repair Shop	55
Radio Room/USAID	38
SMB Warehouse	41
Transportation	26
Air America Radio	37
Air Operation Control (AOC)	21, 25
Airport Support	45
Annex Office	29, 60, 77, 89
Annex Office #2	83
ARMA	14, 24
City Power Office/RLG	32
Consul's Office	16
Continental Air Services Operations (Butler)	36
Medical Unit	19
OICC Office	78
Office Commanding General Region IV	58
P. T. T.	22, 33, 44

S A V A N N A K H E T

Telephone Directory

Area Coordinator	247	FSO (Assistant)	216
ADO	228	LAA	226
Agriculture	219	Maintenance Service	221
Air America Radio	256	Motor Pool	220
Air America Hospital	244	Public Safety	289
AIRA Admin	238	Public Works	296
AIRA Supervisor	231	RD Annex Supervisor	278
AIRA Lounge	232	RD Annex Operations	277
American Club	253	RD Annex Switchboard	275/276
RO English School	274	RD Annex Log.	279
American School, Svkt	241	RO	235/211
ARMA House	295	SMB	265
CASI (Air Ops)	255	Texas Operator	222
CDAAs (CDB)	280	USAID TEL Operator	213/217
Dispensary	272	USAID Switchboard	210
EDU	229	USAID Radio Operator	212
Field Support Officer	234	White House	236

	<u>Res.</u>	<u>Duty</u>		<u>Res.</u>	<u>Duty</u>
Anderson, S.	NA	278	Hill, M.W.	230	276
Barber, O.J.	251	276	Hurd, J.E.	297	275
Bogen, R.K.	257	275	Hurst, P.F.	266	289
Boys, R.C.	NA	276	Kalp, M.K.	292	276
Brunson, G.L.	237	275	Lewis	NA	275
Burton, M.T.	239	276	Loss, W.R.	282	276
Chaves, E.P.	NA	275	Magnani, M.B.	290	275
Costantino, R.N.	258	229	Mixon, D.	298	255
Courtney, D.C.	273	276	Monachino, F.X.	254	272
Crafts, C.E.	284	279	Morgan, M.J.	260	219
Carlson, G.	288	296	Nell, G.L.	286	280
Dacey	NA	275	Poulton, O.J.		275
Day, T.	281	276	Roy, R.	271	235/211
DeMello, J.	262	228	Runyan, R.E. (Flynn)	204	
Dibble, G.K.	248	278	Showalter, L.R.	283	278
Flowers, H.S.	NA	275	Simister, H.	295	295
Gamble, J.B.	287	274	Stone, S.J.	224	247
Gerber, C.			Tadlock, W.G.	261	
Gooldy, T.E.	233	234	West, W.S.	263	276
Green, W.M.	252	278	White House	236	
Grey House (1st floor)	245		Yoshimoto, S.	242	229
(2nd floor)	240		Young, E. J.	291	296
Handley, J.B.	246	275/276	Zapata, N.S.	243	276
Hessel, K.S.	249	255			

ORGANIZATIONS, UNITS, OFFICE LOCATIONS AND MESSENGER
RUN/STOPS OF U. S. MISSION

<u>Symbol</u>	<u>Office Location</u>	<u>Run/Stop</u>	<u>Symbol</u>	<u>Office Location</u>	<u>Run/Stop</u>
AA	Wattay	C-53	IVS	L.P. Road	C-61
AAS	501	B-38	LAA	Rue Yonnet	C-59
ACA	305	B-23	MED	Silver City	C-51
ACC	100	A-10	MGS	That Dam	C-51
AC/VTE	208	A-15	MGT	100	A-02
AC/XK	206	A-14	MSG	That Dam	C-51
AD/FIN	100	A-10	MTB	KM-2	C-62
AD/FO	309	B-35	MTE	210	B-25
AD/M	100	A-02	OB	Silver City	C-58
AD/PE	100	A-04	OD	100	A-01
AD/RA	309	B-22	OFIN	100	A-10
ADMIN	That Dam	C-51	OICC	507	C-56
ADO	Phone Xay	C-55	OPE	100	A-04
AGR	100	A-12	ORA	309	B-22
AIRA	104	B-29	PER	That Dam	C-51
AI-AGR	100	A-12	PERS	100	A-03
AMB	That Dam	C-51	PHD	505	B-34
APO	403	-	PLG	210	B-24
ARMA	504	B-28	PRA	210	B-24
ASB	Wattay	C-52	PMB	210	B-24
AUD	100	A-11	POL	That Dam	C-51
AWC	Comp Hse 4	-	PRO	100	A-05
B&F	That Dam	C-51	PROC	502	A-18
BNDD	That Dam	C-51	PSD	Min/Int	C-54
CASI	Wattay	C-60	PWD	507	B-31
CDS	309	B-35	PWR	210	B-26
C&R	100	A-00	RAA	309	B-22
C&R	That Dam	C-51	RAO	309	B-22
CM	208	A-17	RMB	501	B-30
CSO	100	A-02	RO	506	B-27
COMM	311	B-23	RRB	309	B-22
CONS	That Dam	C-51	RRL	309	B-22
DCM	That Dam	C-51	SCH	KM-6 (LP)	Spec. 100
DD	100	A-01	SCS	502	A-18
EAD	100	A-06	SDS	502	A-18
EAD/PA	Min/Fin	C-63	SMA	502	A-18
ECON	That Dam	C-51	SMB	502	A-18
EDU	100	A-08	SWS	T. Thoum	A-18
EPM	100	A-05	SY	That Dam	C-51
FFP	309	B-22	TEL	401	B-21
FMB	100	A-10	TELE	That Dam	C-51
FHWA	Min/P.W.	C-57	TLS	210	B-37
HRDD	505	B-32	TRP	208	A-16
GSO	Silver City	C-51	USIS	Lane Xang	C-59
HSG	210	B-36	WHSE	Tong Song Nang	B-24
IIS	100	A-00			

<u>JOINT ALERT NOTIFICATION OFFICE</u>		<u>Tel.</u>	<u>Call Sign</u>
JANO		6105	S-26
Alternate JANO		6107	S-25
Assistant JANO		6107	S-19
<u>Sector I</u>	Sector Chief	- J. Ito	6234
	Block Wardens	A - L. Scott	6149
		B - H. Beyda	6236
		C - G. Beery	6298
		D - J. Williams	6242
<u>Sector II</u>	Sector Chief	- C. McElhoo	7120
	Block Wardens	A - T. Coughlin	7197
		B - G. Alba	7395
		C - G. Camarigg	7157
		D - L. Salyer	7176
		E - L. Sproul	6595
		F - R. Hart	6601
		G - F. Manley	7296
<u>Sector III</u>	Sector Chief	- C. Naughton	7183
	Block Wardens	A - A. Enriquez	6514
		B - J. Coughlin	6235
		C - E. Leonard	7197
		D - E. Howell	6635
		E - T. Finby	6403
<u>Sector IV</u>	Sector Chief	- F. Albert	7186
	Block Wardens	A - J. Malia	6460
		B - J. Clore	PTT-3029
<u>Sector V</u>	Sector Chief	- B. Richardson	6219
	Block Wardens		
	Sunset	- J. Howe	6122
		A - D. Johnson	6403
		B - J. Cowlishaw	6533
		C - T. Brown	6530
		D - H. Hartman	6164
		E - W. Pollak	6254
		F - O. Brown	6611
		G - F. Michael	6510
		H - N. Dimmick	6231
<u>Sector VI</u>	Sector Chief	- D. Duke	6519
	Block Wardens	A - F. Wong	6656
		B - E. Reddeg	6566
		C - E. Chan	6516
		C - G. Butler	7168
<u>Sector VII</u>	Sector Chief	- K. Brundage	6274
	Block Wardens	A - C. Gustafson	PTT-2529
		B - P. Fournier	6217
		C - J. Parmenter	6418
		D - W. Allard	7189
		E - J. Barker	7181
<u>Sector VIII</u>	Sector Chief	- M. Fields	K-96

NON-GOVERNMENT ORGANIZATIONS

AIR AMERICA, INC. *

ADMINISTRATION

Base Manager - J.A. Cunningham, Jr.	B-29/B-50/7293
Asst. to Base Manager - G.D. Macpherson	B-29/B-50/7293

PERSONNEL

Personnel Manager - John E. Baird	B-14
Passport and Visa Section	B-62

TECHNICAL SERVICES

Manager, Technical Services - J.A. Pearsall	B-13/B-20
Admin. Assistant - R.E. Smith	B-13/B-20
Special Assistant - A.E. Davis	B-13/B-20

A/Superintendent Aircraft Maintenance - R.L. Peterson		B-80
Acft Maint. Supervisors - Line Office	B-77
Supervisor Shops - T. Usher	B-75
Superintendent Quality Control	B-38
Supervisor Training - Wm. Davidson	B-76
Leadman AES - C.C. Chen	B-74
Planning - K.W. Wong	B-78
Work Control Center	B-79
Aircraft Engineer - K.R. Hou	B-84
Superintendent Supply - R.E. Williams	B-15
Supervisor Store & Issue Unit	B-15
Supervisor Stock Control	B-58/B-99
Supervisor Shipping and Receiving	B-26
Supply Window	B-26
Superintendent General Maintenance - Luther Martin	..B-12/B-55	
Supervisor RGMD	B-55
Supervisor GMD	B-55
Leadman Auto MD (PEMD)	B-28
Power Plant	B-91
Supervisor Comm. Maint - G.K. Boese	B-17
Transmitter Site	B-21
Receiver Site	B-69
Electronic Service Unit (Airborne)	B-73
Supervisor - POL Service - Richard Murtland	B-54
POL Storage	B-67

* See Page 30 for After Hours Numbers.

AIR AMERICA, INC - Cont'd

Superintendent Facilities Development - J.M. Johnson B-55
Technical Library B-85

ACCOUNTING

Manager Financial Affairs - Henry Eby B-72
Accountant B-34

FLIGHT INFORMATION CENTER

Senior Operation Specialist - R. Von Husen B-42
Operation Specialist B-42
Flight Watch Center B-27

OPERATIONS

Senior Operations Manager - Tom Krohn B-30
Duty OM B-23

AFTER 2000H CALL 6505 FOR DUTY OM

Duty OD B-24
Operations Engineer - William H. Syblon B-84
Admin OM - David Chang B-65
Weather B-89
Safety Equipment Office B-63
Supvr Ground Transportation - C.K. Lang B-22

SAFETY

Manager Safety - John D. Anthony B-35

SECURITY

Chief of Security - Ramon R. Hart B-53
Assistant Chief of Security - Ray Reardon B-53
Security Supervisor B-56
Security Guard Main Gate B-86

FIRE BRIGADE

Fire Chief - W. Holden B-52
EMERGENCY NUMBER B-60

AIR AMERICA, INC. - Cont'd

MEDICAL CLINIC

Senior Staff Physician - Dr. A. Liu B-16
Staff Physician - Dr. Lee B-16

TRAFFIC

Traffic Manager - A.R. Brau B-32
Assistant Traffic Manager B-33
Traffic Training Manager B-87
Cargo Control B-33
... .. B-59
Traffic Office International Airport B-66
AAM Terminal B-93
AFD Standby Room B-51

FLYING DEPARTMENT

Manager of Flying - James H. Rhyne B-37
A/Chief Pilot - Gene Hughey B-37
A/Chief Pilot - George Kirkland B-37
Admin. Assistant - Curtis Logsdon B-88
Crew Scheduling B-49

COMMUNICATIONS

Communications Engineer - Vernell Henley B-71
Communications Supervisor B-25
Radio Station B-69
... .. B-70
Telephone Operator B-10
Phone Patch/Attitude B-36
Weather Communications B-64
Data Room B-49
Control Tower & ATC Advisor - Bern Daigle B-95/7338

FLIGHT OPERATIONS TRAINING

Director - Flight Opns Tng Dept - J.C. Thursby B-68
Manager FOTD - D. D. Morgan B-82
Training Instructors B-31
Link Trainer B-31

AIR AMERICA, INC. - Cont'd

FLYING STANDARDS

Manager Flying Standards - D. L. Kosteff	B-81
	B-82

AIR AMERICA CLUB

Club Manager - Fred Burger	B-44
Mess Hall	B-19
Manager Hostels - Laos - Jack Brennan	B-27
Systems Manager - Clubs and Hostel	B-27
James T. McElroy	

NOTE "B" NUMBER EXTENSIONS

Air America Switchboard Operators are on duty to place "B" number calls from 0600H to 2000H daily. To call a "B" number, dial AA Operators at 6601 through 6605 and give the desired "B" number extension.

Between 2000H - 0600 H No operators at the switchboard, the following numbers are connected to ring at the designated locations:

Dial 6601 - connected to B-60 AA Fire Station
Dial 6602 - connected to B-41 CASI Residence Compound
Dial 6603 - connected to B-32 AA Traffic, Passenger & Cargo
Dial 6604 - connected to B-79 AA Tech. Service - Maintenance
Dial 6605 - connected to B-22 AA Motor Pool
Dial 6506 - DUTY OM

A.O.C.	...	B-43/B-45
		7301
ARMA Aviation Office	...	B-94
ESSO	...	B-66
R.L.A.F.	...	B-92
USAID/ASB	...	B-57
USAID/RO - Office	...	7303
USAID/RO - Warehouse	...	B-96

NON-GOVERNMENT ORGANIZATIONS - Cont'd

CONTINENTAL AIR SERVICES, INC.

ADMINISTRATION

General Manager - R. L. Brongersma	6606
					B-46
Station Manager - L. M. Joseph	6606
					B-46
Administrative Assistant - P. M. Gingras	6606
					B-46

FIELD OPERATIONS

Director of Operations - E. B. Dearborn	6606
					B-40
Asst. Director of Operations - F. O. Bell	6606
					B-40

ACCOUNTING OFFICE

Manager - D. L. Patcheak	B-48
--------------------------	-----	-----	-----	-----	-----	------

PERSONNEL OFFICE

...	B-46
-----	-----	-----	-----	-----	-----	------

MAINTENANCE OFFICE

Director of Maintenance - H. J. Sonn	7311
Maintenance Manager - T. A. Quick	7311

SUPPLY OFFICE

Supply Manager - Karl H. Stix	7311
Asst. Supply Manager - Joe Dundon	7311

CASI COMPOUND

...	6608	
						B-41	
					After Office Hours	...	6602

FACILITIES AVAILABLE TO MISSION PERSONNEL

Locations and Hours of Operations

AMERICAN SCHOOL OF VIENTIANE - KM-6, corner of Luang Prabang Street and Second Street

Supt's Office Tel 6486

Prin's Office K-94

Teachers K-94

Office Hours - Monday thru Friday 0730-1630
Saturday and Sunday Closed

Swimming Pool - Hours for recreational swimming
are announced in Khao Lao Tel K-76

Pre-School - KM-6 Near Entrance Gate Tel K-184

School Hours - Monday thru Friday 0830-1130
Saturday and Sunday Closed

APO MAIL ROOM - Na Hai Diao Compound - Bldg. 403 Tel 6114

Stamps Purchase and Parcel Mailing
Monday thru Friday 0830-1230
Saturday 0900-1200

Open for Mail Pick-Up ONLY
Monday, Wednesday & Friday 1630-1730
Tuesday and Thursday 1430-1730

Monday Order & Registry Service
Bi-weekly Dates posted inside APO

Pick-up of Letters and Sack Mail 1100 & 1630

Accountable Mail - may be picked anytime the APO is open

Holiday Schedule - posted in Khao Lao

Monday, Wednesday and Friday (Closed) 1430-1630
Sunday Closed

FACILITIES AVAILABLE - Cont'd

Commissary - Located at Building 311 T, Na Hai Diao Compound Tel 6149

Field Orders Tel 6469

Commissary	Monday	0900-1600
Hour	Tuesday	0900-1600
	Wednesday	1300-1900
	Thursday	0900-1600
	Friday	0900-1600
	Saturday	0800-1400

AMERICAN WOMEN'S CLUB - Located At Compound Hse #4 Tel 6488

	<u>Club Hours</u>	<u>Library</u>	<u>Glass Rental*</u>	<u>Thrift Shop*</u>
Monday	0900-1100	1000-1100 1700-1800	1000-1100	0930-1200
Tuesday	ditto	ditto	ditto	ditto
Wednesday	ditto	ditto	ditto	ditto**
Thursday	ditto	ditto	ditto	ditto
Friday	ditto	ditto	ditto	ditto
Saturday	--	0930-1200	ditto	ditto
Sunday	--	1000-1100	--	--

* Thrift Shop - located at Bldg. 303, Na Hai Diao Compound

** Wednesday open for merchandise receiving only.

CHURCH - CATHOLIC - Immaculata Catholic Church Tel PTT 2251
 Located KM-3, Thadeua Road
 (opposite Salakoktane Hse #1)

Schedule of Service - in English

Sunday Mass	0930H
Weekday Mass (Monday thru Friday)	0630H
Saturday Mass (Evening)	1730H
Saturday Evening - Perpetual Help Novena		1715H
Confession - 30 minutes before each mass		

Attendance at Saturday evening Mass fulfills the Sunday Obligation.

FACILITIES AVAILABLE - Cont'd

CHURCH OF CHRIST - Located at Nong Bone Hse #8

Bible Classes - Sunday 0930
Worship - Sunday 1100

Contact Curtis LOGSDON c/o Air America, Inc. Tel B-88

CHURCH - INTERNATIONAL PROTESTANT

An International and Interdenominational Church,
located at Dong Sapahngmo Area (Office) PTT Tel 2529

Pastor's Residence Tel 6208

Sunday School - Classes for all ages 0950
(Bus running from KM-6 at 0930)

Morning Worship Service 1100

Singspiration at the Parsonage ... 1930

Wednesday Evening - Prayer and
Bible Study at Parsonage 1930

CHURCH - OF JESUS CHRIST OF LATTER DAY SAINTS (MORMON)

Junior Sunday School (Sunday) 1030
KM-6 204 Second St.
Contact Kenneth G. WAGNER Tel K-124

Sacrament Meeting (Sunday) 1800
Building #503, Na Hai Diao Compound
Contact Gail POULTON Tel 6458/
6565

CHURCH - OF THE HOLY SPIRIT

The Anglican/Episcopalian congregation in Vientiane conducts Church Services twice monthly in the International Protestant Church on: The first & third Sunday of each month at 1800.

FACILITIES AVAILABLE - Cont'd

CHURCH - SEVENTH-DAY ADVENTIST

P.O. Box 689 Vientiane - Pastor Angel G. Biton
Services held at No. 6 Oupmoung #2 Luang Prabang Road
Sabbath School (Saturday) 0930H
Church Service (Saturday) 1030H

GUEST HOUSE - For reservation - Contact Housing Section

Building 210 Tel 6178/6180

New Guest House Tel 6128
Guest House #3:
Room Nos. 301, 302, 303 Tel 6161
Room Nos. 304, 305, 306 Tel 6165
Room Nos. 307, 308, 309 Tel 6166
Room Nos. 310, 311, 312 Tel 6168
Room Nos. 313, 314 Tel 6170

LEEVILLE HOUSES

Manager Tel 6672

LAO AMERICAN ASSOCIATION (LAA) Tel 7158/
7258

Vientiane - Located at Rue Yonnet, opposite the National
Bank of Laos - Fountain Square Area.

Hours - Monday thru Friday ... 0800-1300
1430-1730
Saturday & Sunday ... Closed

Luang Prabang

Monday thru Friday ... 0900-1900
Saturday 0900-1200
1400-1700
Sunday 1400-1700

FACILITIES AVAILABLE - Cont'd

Savannakhet

Monday thru Friday ... 0730-1200
1430-1930
Saturday 0730-1200

MEDICAL UNIT - Located at Silver City - opposite Vientiane Hospital

Hours - Appointment

Monday thru Friday ... 1430-1630

- Sick Calls

Monday thru Friday ... 0730-1130
Saturday 0900-1100

- Sunday Closed

USIS LIBRARY

Vientiane - USIS Building - Lane Xang Avenue

Monday thru Friday ... 0730-1200
1430-1800

Saturday 0730-1200

Sunday Closed

FACILITIES AVAILABLE - Cont'd

SHUTTLE BUS SCHEDULE - KM-6

<u>LV ACA</u>	<u>LV KM-6</u>	<u>ARR ACA</u>
0630*	0700	0730
0645*	0720	0750
0700	0735	0800
0800	0830	0900
0930	1000	1030
1100	1130	1200
1230	1330	1400
1305	1405	1430
1500	1530	1600
1700	1730	1800
1735	1800	1830
1800	1830	1900
1930	2000	2030
2030 (or later-depends on movie)	2100	2130
2230 "	2300	2330

*Work days only.

KM-6 shuttle buses will drive around the KM-6 area twice to discharge passengers and to pick up passengers except when the bus is already loaded. There may be times when the bus is delayed and time is short and the driver will be unable to drive around the area twice but this should be the exception rather than the rule.

CITY EXCHANGE NUMBERS

PTT

AIRLINES

Aeroflot	PTT-3501
Air France	PTT-2521
Air Vietnam	PTT-2314
China Airlines	PTT-2787
Japan Airlines	PTT-3760
Lao Air Charter	PTT-2421
Lao Airlines	PTT-2328
Lao Air Development	PTT-7305
Lao United Airlines	PTT-2768
Northwest Airlines	PTT-2855
Northwest Orient	PTT-2561
Pan American	PTT-3256
Royal Air Laos	PTT-2094
Thai Airways	PTT-3136
TWA	PTT-2473
Veha Akat	PTT-2768

BANKS

Bank Indochina	PTT-2646
Bank Lao-Vieng	PTT-2176
Bank of Lao Development	PTT-2325
Bank of Vientiane	PTT-2597
National Bank of Laos	PTT-2000
The Laos Commercial Development Bank	...	PTT-2658

BUSINESSES

American Transpack	PTT-2600
Bird & Sons, Inc.	PTT-2493
Caltex Co.	PTT-2555
Dell Co., Ltd.	PTT-2649
Dennis Freres	PTT-2546
Dolorfino Construction	PTT-3976
ECCOI (Col. Enriquez)	C-6514
EPC - Vientiane	PTT-3189
ESSO Standard Eastern Ltd.	PTT-2720
Garage Sidamdouane	PTT-2267
Hines International	PTT-2473
ITT - Federal Electric Corp.	C-6414
Kaye Ando Technical/Travel Services	PTT-2760

CITY EXCHANGE NUMBERS (PTT) - Cont'd

B U S I N E S S E S - Cont'd

Lao Art Center	PTT-2776
Lao Japan Trading Co.	PTT-3241
Lao Wood Industries (TADA's):		
Na Hai Diao	PTT-3451
Phone Saat	PTT-3452
That Luang	PTT-3453
Manley Enterprise	PTT-3256
PAGE	C-6414
Prajayantra Co. (V.W.)	PTT-2399
Shell Direction (Sithan Neua)	PTT-2496
Sino-British	PTT-2855
SOGIMEX	PTT-2532
Summit Lao (Summit Ind. Corp.)	PTT-3189
Thao Bo Transportation	PTT-3331
Universal Services Co.	PTT-3581
Van Service Worldwide	PTT-2299

CHURCHES/MISSIONS

Bishop Catholic Mission - Tha Deua Road	PTT-3229
Catholic Mission	PTT-2251
Notre Dame Catholic Church	PTT-3402
Protestant Mission	PTT-2529
The Laos Evangelical Church - Dong Sisangvone	PTT-3552

HOSPITALS/CLINICS

Clinic Metaasouk	PTT-3801
Mahosot Hospital	PTT-2223
Sisavangvong Military Hospital	PTT-2818
Vientiane Hospital (OB)	PTT-2605
		C-6444/7207

H O T E L S

Anou Hotel	PTT-2660/2562
Apollo Hotel	PTT-2899/2849/ 3305

CITY EXCHANGE NUMBERS (PTT) - Cont'd

H O T E L S - Cont'd

BIS Hotel	PTT-2514
Constellation Hotel	PTT-3287
International Hotel	PTT-2408/2482
Lane Xang Hotel	PTT-2672
Lido Hotel	PTT-2680
Sayfa Hotel	PTT-2540
Settha Palace	PTT-2469
Vientiane Hotel	PTT-3063

INTERNATIONAL ORGANIZATIONS

Asia Foundation - Office	PTT-2226
- Residence	PTT-2359
Asia Christian Service	PTT-2803
Catholic Relief Service	PTT-2251
Colombo Plan	PTT-2570
Dooley Foundation	PTT-3633
I. C. C. - Canadian Delegation	PTT-2364
- Indian Delegation	PTT-2614
- Polish Delegation	PTT-2620
International Red Cross	PTT-3226
Japanese Voluntary Service	PTT-2712
UNO - Office	PTT-2342
- Rep. Res.	PTT-2634
W. H. O.	PTT-2096
World Vision	PTT-2858

R E C R E A T I O N S

Lao Bowling Center	PTT-2018
--------------------	--------	----------

RLG OFFICES

Agriculture Ext. - Office of Director	PTT-2738
Chao Khoueng's Office	PTT-2556/2627
City Electricity	PTT-2216
City Water Center	PTT-2471
Civil Aviation	PTT-2093
Commission of Rural Affairs (CRA)	PTT-2202
Government Printing Office	PTT-2806

CITY EXCHANGE NUMBERS (PTT) - Cont'd

RLG OFFICES - Cont'd

Lao National Radio Broadcasting	PTT-2457
Lao Photo Presse	PTT-2717
Lao Veterinary Service	PTT-2319
Mekong Committee	PTT-2732
Military Central - Chinaimo	PTT-3151
- Phone Kheng Camp	PTT-3360
- Wattay	PTT-3131
Military Central SWBD	PTT-2326
Military Hospital	PTT-2017
Police - Academy	PTT-2549
- Director General's Office	PTT-2509
- Emergency/Rescue	PTT-2053
- Fire Department	PTT-18
- Metropolitan	PTT-2052
- Traffic	PTT-17
Post Office - Morning Market	PTT-2235
Prefect's Office	PTT-2610
Royal Palace Central SWBD	PTT-2340
Telephone - INFORMATION	PTT-12/13
Telephone - REPAIR	PTT-11

SCHOOLS

German-Lao Technical School	PTT-2382
International School	PTT-2616
Lycee de Vientiane	PTT-2708
Maternity School	PTT-2617
National Education Center (ESP) - KM-9	PTT-2291
Natthasin School	PTT-2628
School of Medicine	PTT-2607
Vocational School	PTT-2711

MINISTERS AND SECRETARIES OF STATE
ROYAL LAO GOVERNMENT

Prime Minister	PTT-2124
Secretary General	PTT-2151
Minister of Finance	PTT-2320
Principal Private Secretary	PTT-2239 Ext. 25
Minister of Fine Arts - Director	PTT-2340 Ext. 6
Minister of Foreign Affairs	PTT-2107
Minister of Interior	PTT-2225
Director General	PTT-2667
Minister of Justice	PTT-2145
Director General	PTT-2008
Minister of National Economy	PTT-2650
Director General	PTT-2200
Minister of National Education	PTT-2050
Director General	PTT-2213 Ext. 132
Minister of National Information	PTT-2626
Director General	PTT-2594
Minister of National Defense	PTT-2500
Minister of Plan and Cooperation	PTT-2404
Commissioner of Plan	PTT-2655
Minister of Post and Telecommunications	PTT-2716
Director General	PTT-2740
Minister of Public Works and Transportation	PTT-2587
Director General	PTT-2388
Minister of Religious Affairs	PTT-2735
Secretary	PTT-2212
Secretary of State for Public Health	PTT-2390
Director General	PTT-2710

MINISTERS AND SECRETARIES OF STATE (RLG) - Cont'd

Secretary of State for Rural Affairs	PTT-2137
Secretary of State for Social Welfare	PTT-2679
Director General	PTT-2533
Secretary of State for Sports/ and Youth	PTT-2670
Director	PTT-2160
Secretary of State for Veterans Affairs	PTT-2022

EMBASSIES

Australia	PTT-2477
Burma	PTT-2274
Cambodia	PTT-2033
France	PTT-2377/2642
Great Britain	PTT-2333
India	PTT-2255/2410
Indonesia	PTT-2370
Japan	PTT-2584/2316
North Vietnam	PTT-2707
Philippines	PTT-2261
South Vietnam	PTT-2305
Thailand	PTT-2543/2508
U. S. S. R.	PTT-2012

USAID/LAOS FLIGHT SCHEDULE

MON Milk Run South C-46	TUE Milk Run North C-46	TUE Comm Flight C-46	THU Milk Run South C-46	FRI Milk Run North C-46	Read Down	Area	Read Down	MON Milk Run South C-46	TUE Milk Run North C-46	THU Comm Flight C-46	THU Milk Run South C-46	FRI Milk Run North C-46
0830	0900	0800	0830	0900	Lv	Vientiane	Ar	1650	1550	1545	1650	1610
↓		↓	↓	0920	Ar	*Vang Vieng *	Lv	↑		↑		1550
				0950	Lv	*Vang Vieng *	Ar					1520
				1010	Ar	Sayaboury	Lv					1500
				1020	Lv	Sayaboury	Ar					1430
				1040	Ar	Luang Prabang	Lv					1410
				1110	Lv	Luang Prabang	Ar					1340
				1200	Ar	*Ban Houei Sai *	Lv					1250
				0945	Ar	Savannakhet	Lv					1535
				1015	Lv	Savannakhet	Ar					1505
				1115	Ar	Pakse	Lv					1405
		0945		Ar	Bangkok	Lv		1400				

* Flag Stop

SCHEDULE EFFECTIVE 1 AUGUST 1971

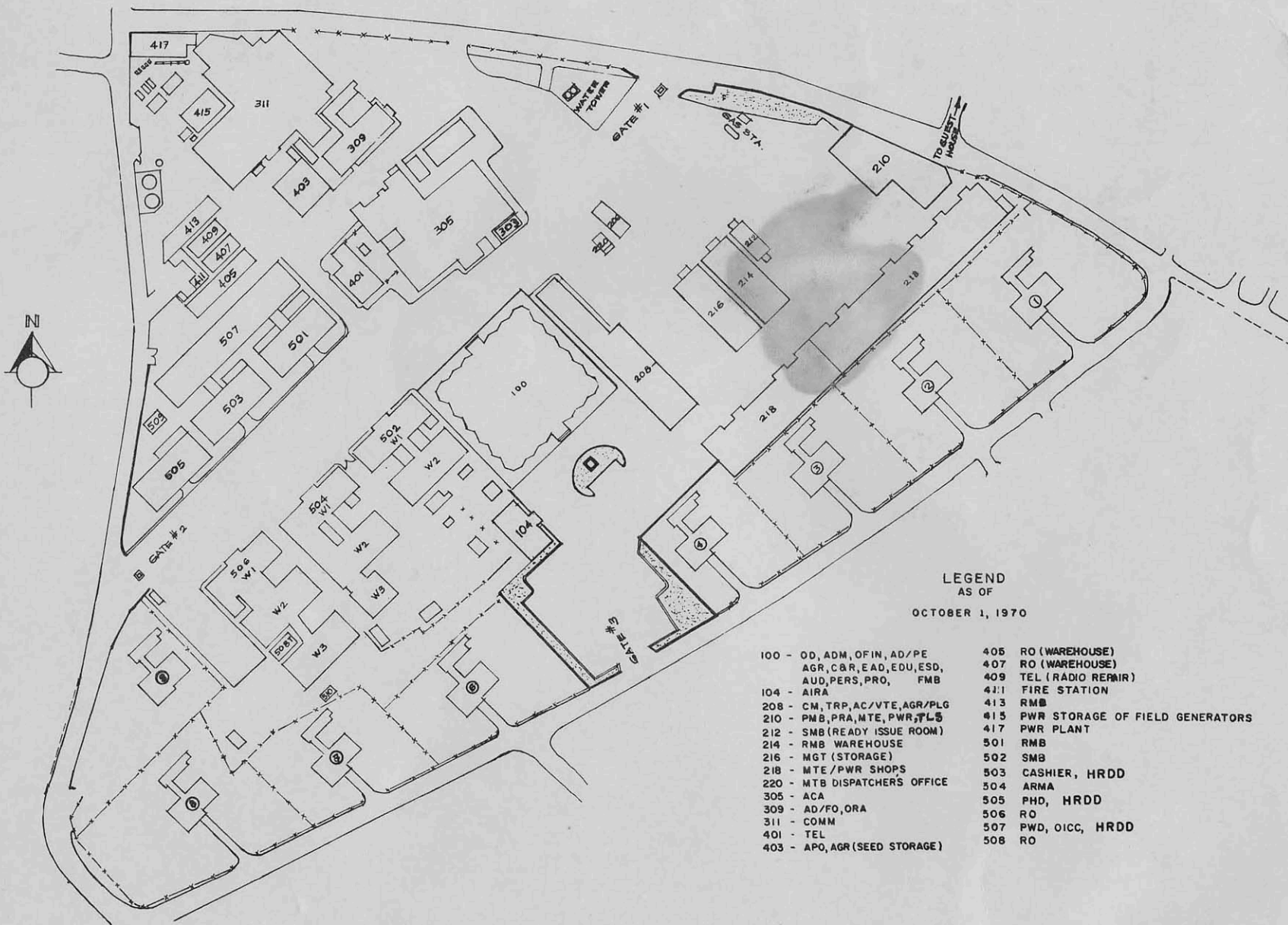

LEGEND
AS OF

OCTOBER 1, 1970

- | | |
|--------------------------------|-------------------------------------|
| 100 - OD, ADM, OFIN, AD/PE | 405 RO (WAREHOUSE) |
| AGR, C&R, EAD, EDU, ESD, | 407 RO (WAREHOUSE) |
| AUD, PERS, PRO, FMB | 409 TEL (RADIO REPAIR) |
| 104 - AIRA | 411 FIRE STATION |
| 208 - CM, TRP, AC/VTE, AGR/PLG | 413 RMB |
| 210 - PMB, PRA, MTE, PWR, PLS | 415 PWR STORAGE OF FIELD GENERATORS |
| 212 - SMB (READY ISSUE ROOM) | 417 PWR PLANT |
| 214 - RMB WAREHOUSE | 501 RMB |
| 216 - MGT (STORAGE) | 502 SMB |
| 218 - MTE/PWR SHOPS | 503 CASHIER, HRDD |
| 220 - MTB DISPATCHERS OFFICE | 504 ARMA |
| 305 - ACA | 505 PHD, HRDD |
| 309 - AD/FO, ORA | 506 RO |
| 311 - COMM | 507 PWD, OICC, HRDD |
| 401 - TEL | 508 RO |
| 403 - APO, AGR (SEED STORAGE) | |

